

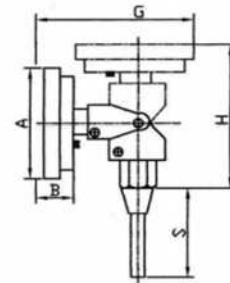

## INDUSTRIAL THERMOMETER

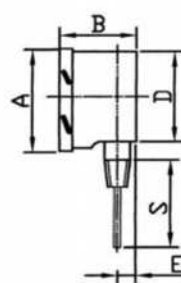
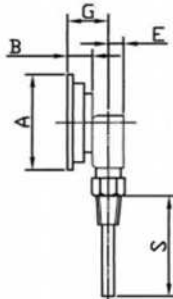
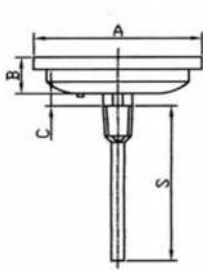
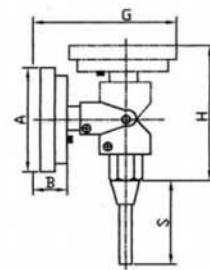
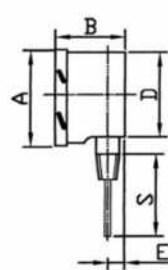
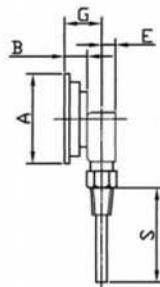
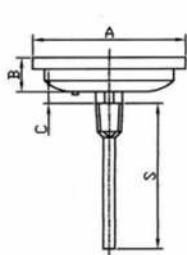
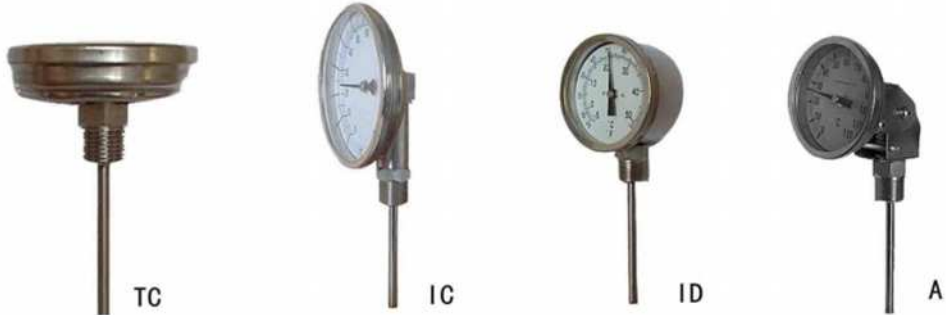

ITEM	NUMBER	DIAL SIZE	A	B	C	D	E	H	G	S	CONN	HEX
TC	T300C	3"	83.5	22.0	10.0	-	-	-	-	*	1/2"NPT	21
	T400C	4"	110.0	23.0	10.0	-	-	-	-	*	1/2"NPT	21
	T500C	5"	134.0	23.0	10.0	-	-	-	-	*	1/2"NPT	21
IC	I300C	3"	83.5	22.0	-	-	11.0	-	33.0	*	1/2"NPT	21
	I400C	4"	110.0	25.0	-	-	11.0	-	34.0	*	1/2"NPT	21
	I500C	5"	135.0	23.0	-	-	11.0	-	34.0	*	1/2"NPT	21
ID	I300ID	3"	77.0	43.5	-	68.7	12.0	-	-	*	1/2"NPT	21
	I400ID	4"	109.0	47.0	-	100.5	12.0	-	-	*	1/2"NPT	21
	I500ID	5"	127.0	45.5	-	119.5	12.0	-	-	*	1/2"NPT	21
	I600ID	6"	158.0	45.0	-	150.7	12.0	-	-	*	1/2"NPT	21
A	A300	3"	77.0	15.0	-	-	-	97.0	93.5	*	1/2"NPT	21
	A400	4"	109.0	20.0	-	-	-	98.0	116.0	*	1/2"NPT	21
	A500	5"	127.0	19.5	-	-	-	101.0	125.5	*	1/2"NPT	21

[www.viaindustrial.com](http://www.viaindustrial.com)