

BA2M-DDT

Small size, long distance diffuse reflective type

■ Features

- Capability of detecting long distance (2m) by special optical design.
- Stable received light indicator built in.
- Sensitivity adjustment function built in.
- 2 color LED display.

 Please read "Caution for your safety" in operation manual before using.



■ Specifications

Model	BA2M-DDT
Type	Diffuse reflective
Detecting distance(*)	2m
Detecting target	Transparent, Translucent, Opaque material
Hysteresis	Max. 20% at rated setting distance
Response time	Approx. 1ms
Power supply	12~24VDC \pm 10% (Ripple P-P : Max. 10%)
Current consumption	Max. 15mA (Max. 30mA when the output is ON)
Light source	Infrared LED (850nm modulated) □
Sensitivity adjustment	Adjustable VR
Operation mode	Light ON (Dark ON mode is optional)
Control output	NPN open collector output <input checked="" type="checkbox"/> Load voltage : Max. 30VDC, Load current : Max. 100mA, Residual voltage : Max. 1V
Protection circuit	Reverse polarity protection, Output short-circuit protection
Receiver	Photo diode (Built-in IC) □
Indication	2 color LED [Operation : Red, Stability : Yellow (Red+Green)]
Insulation resistance	Min. 20M Ω (at 500VDC)
Noise strength	\pm 240V the square wave noise (pulse width:1 μ s) by the noise simulator
Dielectric strength	1000VAC 50/60Hz for 1minute
Vibration	1.5mm amplitude at frequency of 10 ~ 55Hz in each of X, Y, Z directions for 2 hours
Shock	100m/s ² (10G) in X, Y, Z directions for 3 times
Ambient illumination	Sunlight : Max. 10,000lx, Incandescent lamp : Max. 3,000lx
Ambient temperature	-20 ~ +55 $^{\circ}$ C (at non-freezing status), Storage : -25 ~ +70 $^{\circ}$ C
Ambient humidity	35 ~ 85%RH
Protection	IP50 (IEC specification)
Material	Case : PBT, Lens : PMMA
Cable	3P, ϕ 3mm, Length : 2m
Accessory	Sensitivity adjustment tool
Approval	CE
Weight	Approx. 50g

(*) It is for Non-glossy white paper (200 \times 200mm).

DC Long Distance Diffuse Type

Characteristic

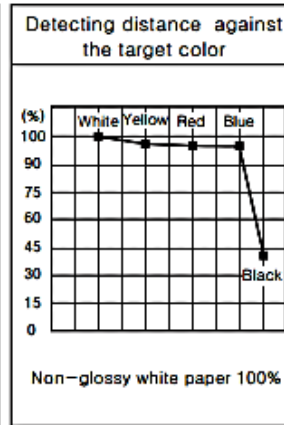
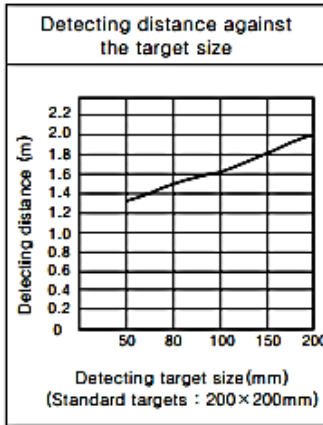
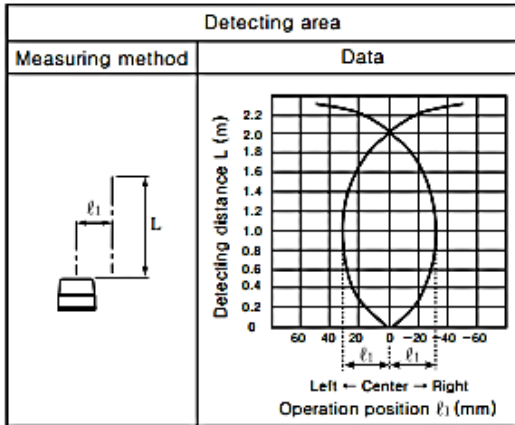

Control output diagram

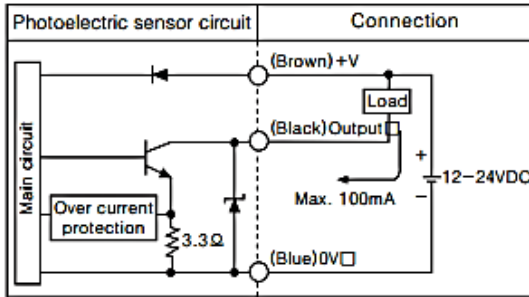

Operation mode

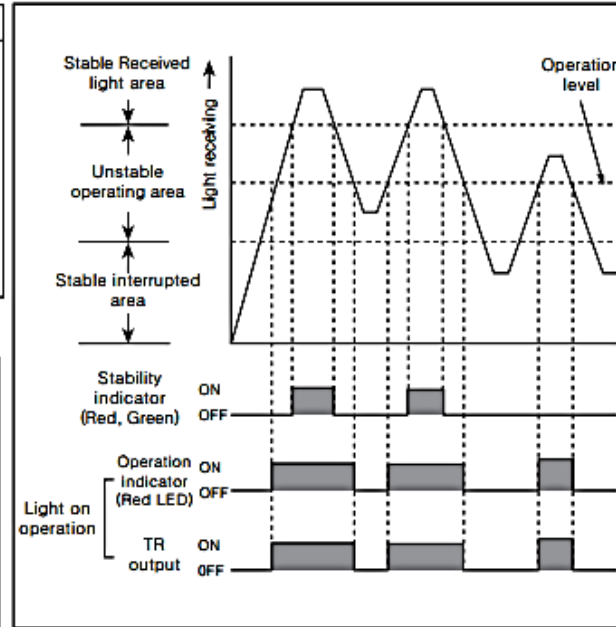

Connections

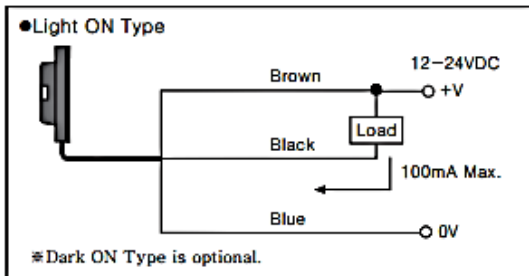

Dimensions

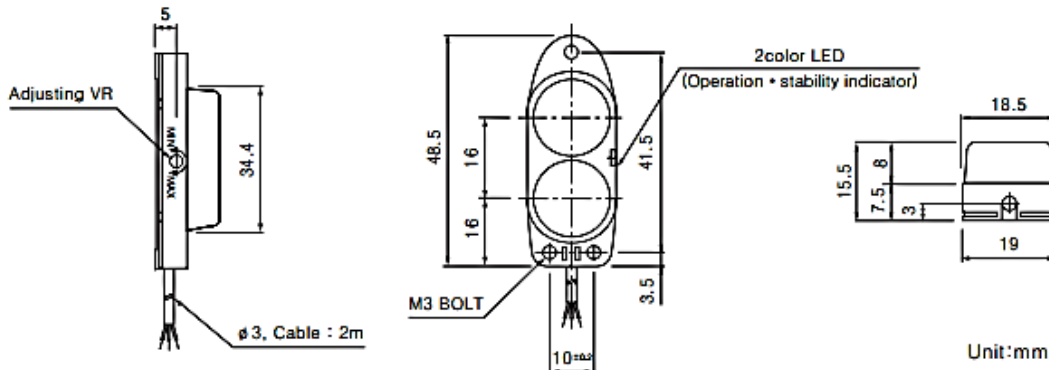

(A) Counter

(B) Timer

(C) Temp. controller

(D) Power controller

(E) Panel meter

(F) Tacho/Speed/Pulse meter

(G) Display unit

(H) Sensor controller

(I) Proximity sensor

(J) Photo electric sensor

(K) Pressure sensor

(L) Rotary encoder

(M) 5-Phase stepping motor & Driver & Controller